

A55

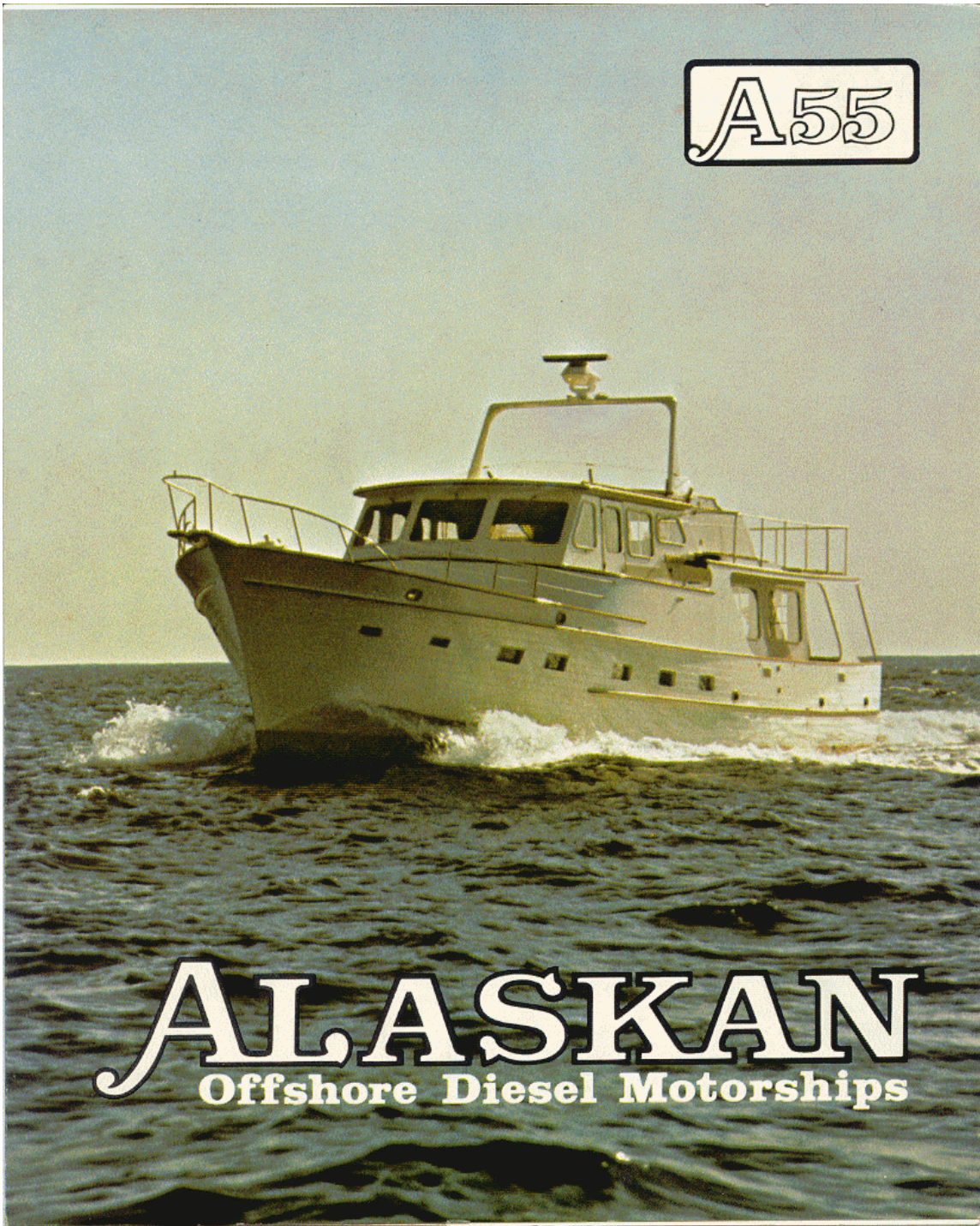

ALASKAN

Offshore Diesel Motorships

A55

SPECIFICATIONS

- L.O.A. 54'9"
- L.W.L. 49'10"
- Beam 17'1"
- Draft 5'6"
- Freeboard:
 - Forward ... 9'3"
 - Aft 5'0"
- Displacement ... 91,000 lbs.
- Capacities:
 - Fresh Water 600 gals.
 - Fuel 1800 gals.
- Range over 1800 miles
- Sleeping Accommodations 9 (all over 6')
- Cockpit 7' x 14'
- Deck Saloon 17' x 11' (incl. galley)
- Headroom 6'4"
- Construction Philippine mahogany planking over yacal frames, keel and engine beds, fastened with silicon bronze screws and bolts.

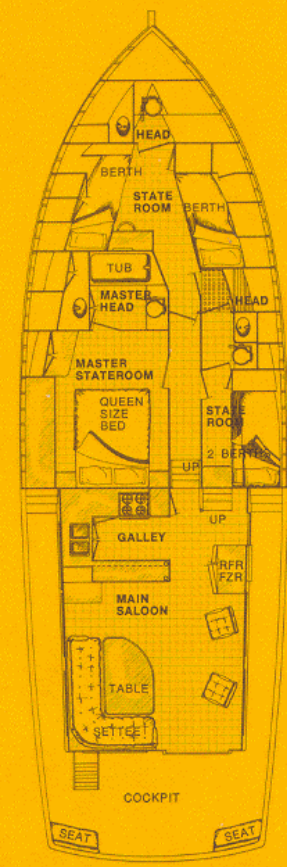
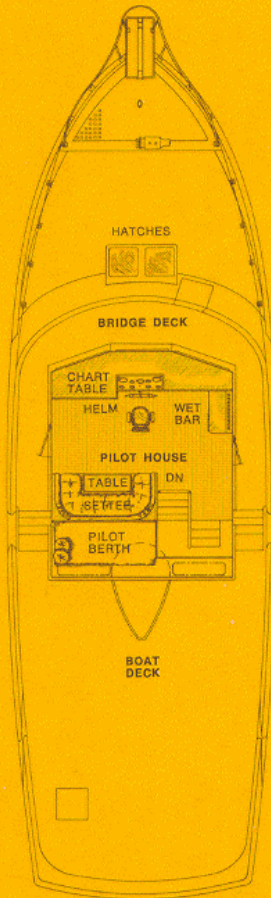

ALASKAN

Offshore Diesel Motorships

A49 A55 A62 A76

AMERICAN MARINE, LTD.

"KNOWN THROUGHOUT THE WORLD FOR QUALITY CRAFTSMANSHIP"
 1501 Westcliff Drive, Suite 201 • Newport Beach, Calif. 92660
 ©1971 AMERICAN MARINE LTD. PRINTED IN U.S.A.

